



RiverOak Strategic Partners

5.2-4 Environmental Statement Volume 4: Figures

TR020002/ APP/ 5.4

Project Name:	Manston Airport Development Consent Order
Regulation:	Regulation 5(2)(a) of the Infrastructure Planning (Applications: Prescribed Forms and Procedure) Regulations 2009, as amended
Date:	July 2018

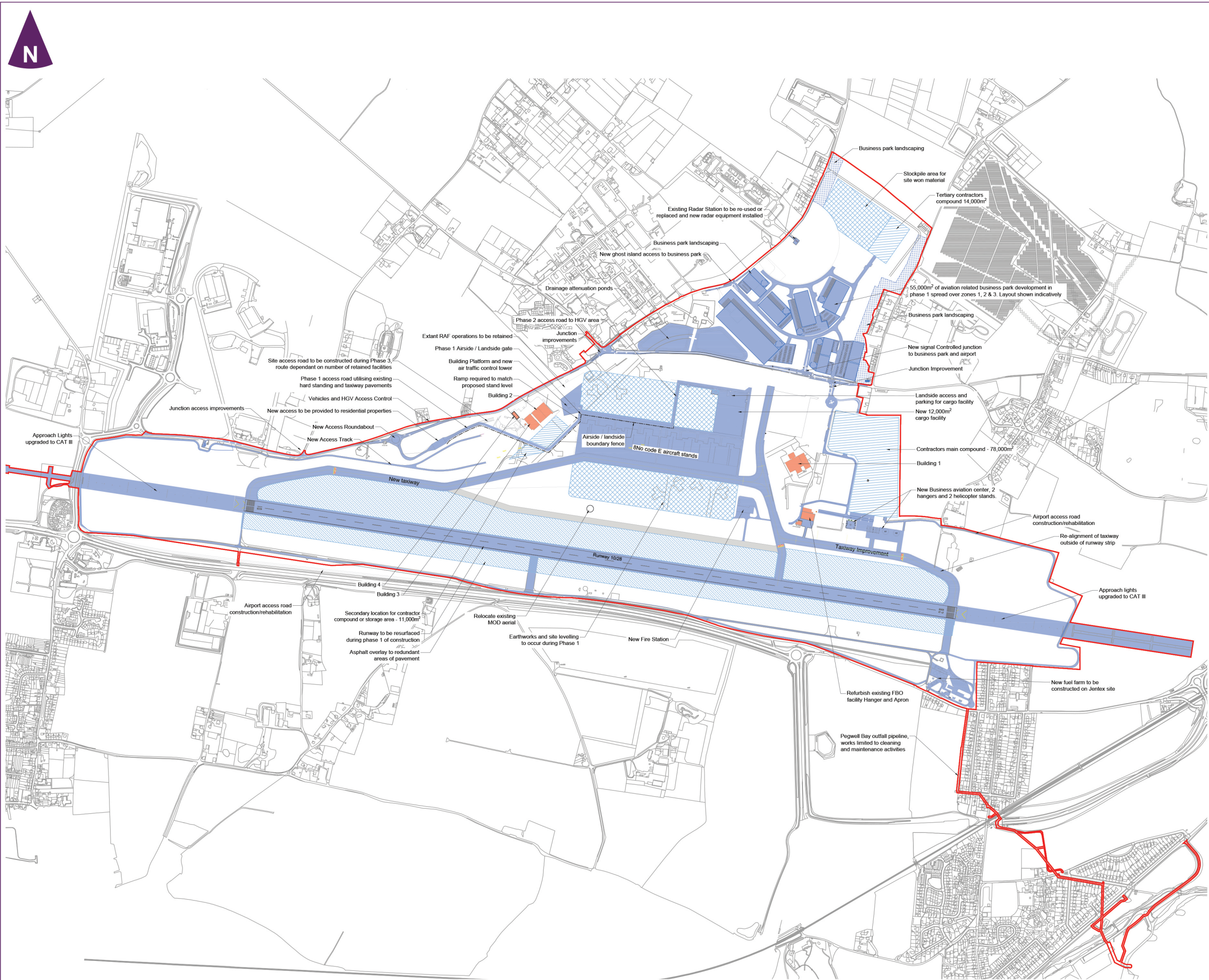



Key

Order Limits

Phase 2 Compound(s)

Phase 2 Construction

Earthworks and Site Clearance

Works completed in previous phase

Area cleared and levelled in previous phase

Existing buildings to be retained

PHASE 2		
	Constructed in Phase 2	Site Total
Code E Stands	6	14
Code C Passenger Stands	3 (Refurbished)	3
Cargo Facilities	16,500 m²	28,500 m²
Non Aircraft Pavement	95,000 m²	865,000 m²
Aircraft Pavement	102,825 m²	496,447 m²
Landside Business Development	50,100m²	105,100m²
Business Aviation Hangars (Helipads)	4	6(2)
Recycling Hangars and Aprons	1	1
Construction Compounds	3	-

- NOTES
1.

OS data obtained from emapsite™ May 2017: © Crown copyright and database rights 2017. Ordnance Survey 0100031673
2.

All phasing elements are shown for illustrative purposes only. Final development of the site will be to suit emerging business needs
3.

Ancillary works such as AGL, nav aids, and service connections are not shown
4.

Works are shown for illustrative purposes only
- Note:

Based on original drawing “RPS-MSE-XX-DR-C-2042_P05” supplied by RPS

Client

RSP

Manston Airport DCO
Environmental Statement

amc
foster
wheeler

Figure 3.8
Masterplan - Phase 2 phasing plan

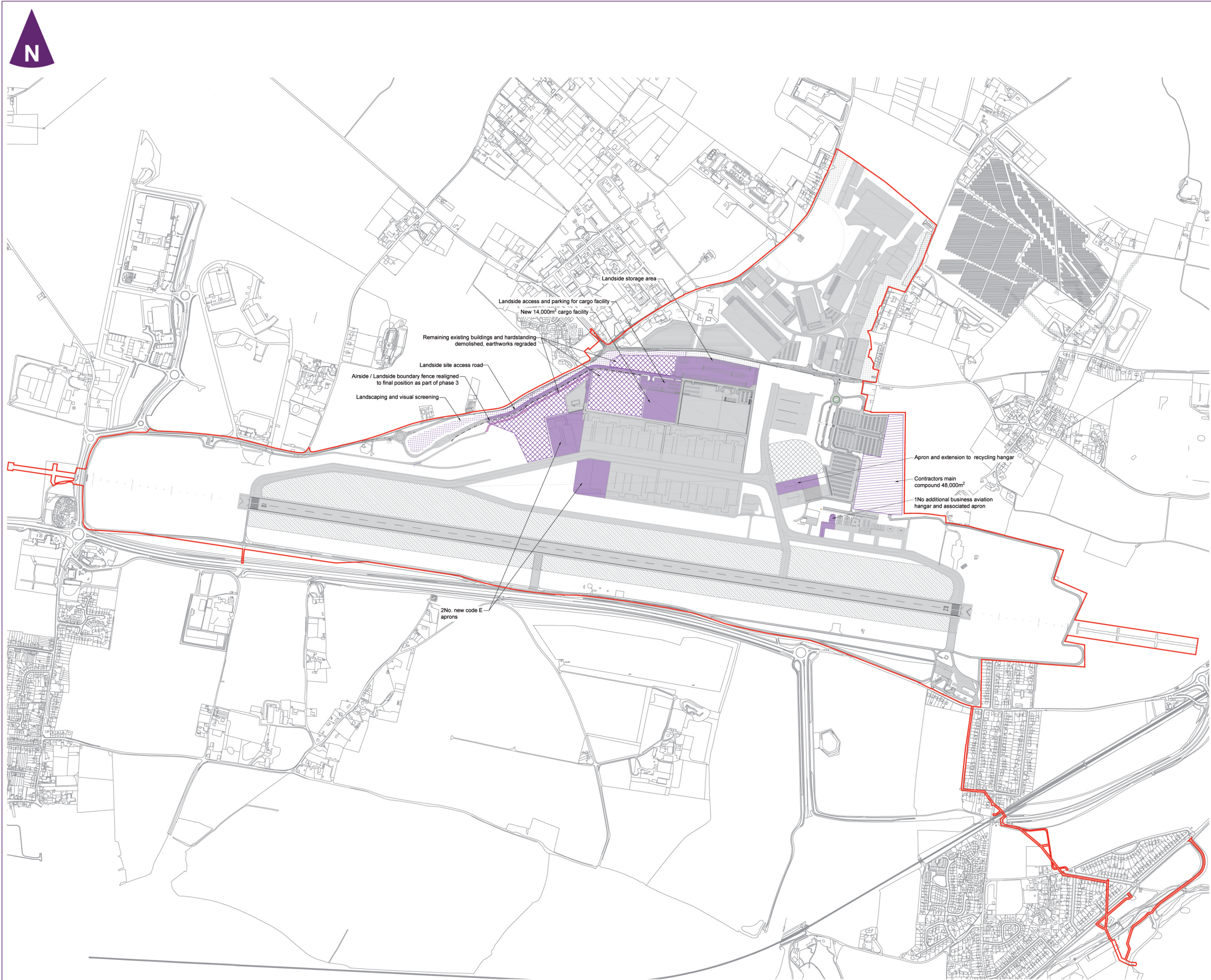

Key

Order Limits

Phase 3 Compound(s)

Phase 3 Construction

Earthworks and Site Clearance

Landscaping

Works completed in previous phases

Area cleared and levelled in previous phase

PHASE 3		
	Constructed in Phase 3	Site Total
Code E Stands	2	16
Code C Passenger Stands	0	3
Cargo Facilities	14,000 m²	42,500 m²
Non Aircraft Pavement	59,000 m²	924,000 m²
Aircraft Pavement	43,463 m²	539,910 m²
Landside Business Development	0m²	105,000m²
Business Aviation Hangars (Helipads)	1	7(2)
Recycling Hangars and Aprons	1	2
Construction Compounds	1	-

- NOTES
1.

OS data obtained from emapsite™ May 2017: © Crown copyright and database rights 2017. Ordnance Survey 0100031673
2.

All phasing elements are shown for illustrative purposes only. Final development of the site will be to suit emerging business needs.
3.

Ancillary works such as AGL, nav aids, and service connections are not shown.
4.

Works are shown for illustrative purposes only

Note:
Based on original drawing “RPS-MSE-XX-DR-C-2043_P06” supplied by RSP

Client

RSP

Manston Airport DCO
Environmental Statement

amc
foster
wheeler

Figure 3.9
Masterplan - Phase 3 phasing plan



Key

- Order Limits
- Phase 4 Compound(s)
- Phase 4 Construction
- Works completed in previous phases

PHASE 4		
	Constructed in Phase 4	Site Total
Code E Stands	3	19
Code C Passenger Stands	1	4
Cargo Facilities	23,000 m²	65,500 m²
Non Aircraft Pavement	72,500 m²	996,500 m²
Aircraft Pavement	33,900 m²	573,810 m²
Landside Business Development	0m²	105,100m²
Business Aviation Hangars (Helipads)	1	8(2)
Recycling Hangars and Aprons	1	3
Construction Compounds	1	-

- NOTES**
- OS data obtained from emapsite™ May 2017: © Crown copyright and database rights 2017. Ordnance Survey 0100031673
 - All phasing elements are shown for illustrative purposes only. Final development of the site will be to suit emerging business needs
 - Ancillary works such as AGL, nav aids, and service connections are not shown.
 - Works are shown for illustrative purposes only

Note:
Based on original drawing “RPS-MSE-XX-DR-C-2044_P06” supplied by RSP

Not to scale

Client

RSP

Manston Airport DCO
Environmental Statement

amec
foster
wheeler

Figure 3.10
Masterplan - Phase 4 phasing plan



0m 500m

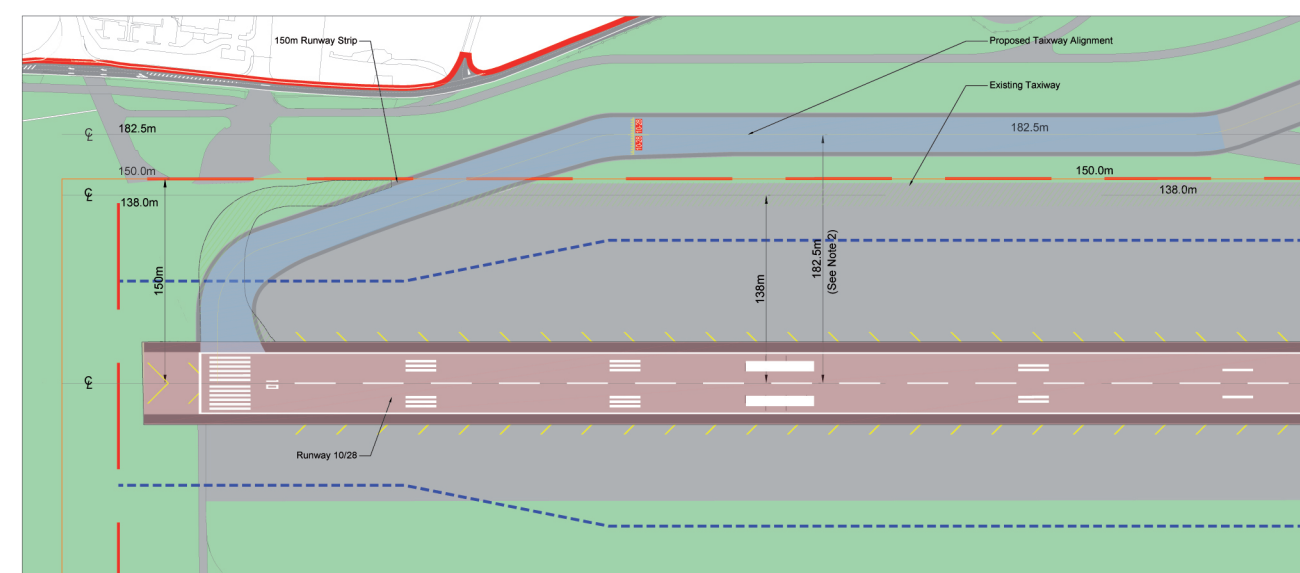

0m 250m

EASA Document: Certification Specification For Aerodrom
Clause CS.ADR-DSN.D.260

Note:
Based on original drawing "RPS-MSE-XX-DR-
C-2005_P03" supplied by RPS

RSP



Figure 3.11
Runway-taxiway alpha interference